



PEPE di Alberto Barbieri & C. Sas - S.S. per Genova, 58/B - 15057 Tortona (AL)

CANALE (COD: CCI 25)

Armatura: rete ϕ 5, maglia 15 x 15

Calcestruzzo: Rck 250

Peso Teorico: kg/m. 246 ~

Sollevamento: n. 1 foro per parete

Lunghezza: cm. 250

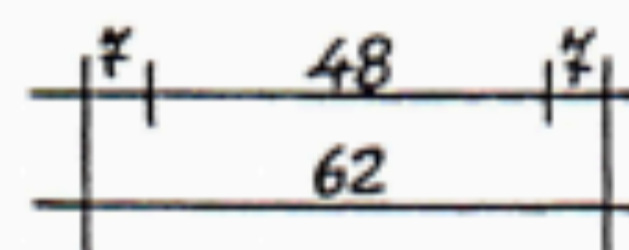
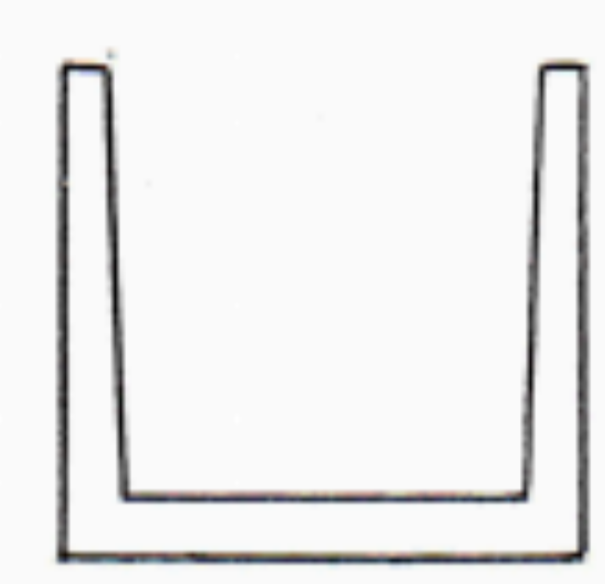
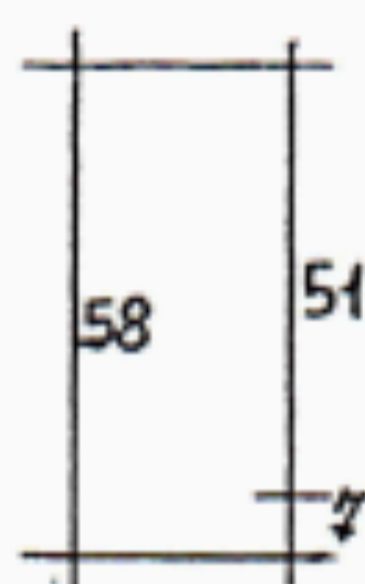
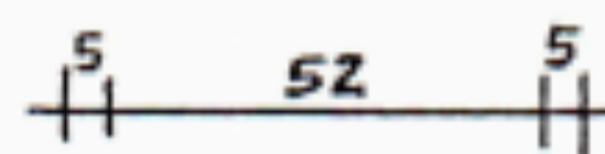
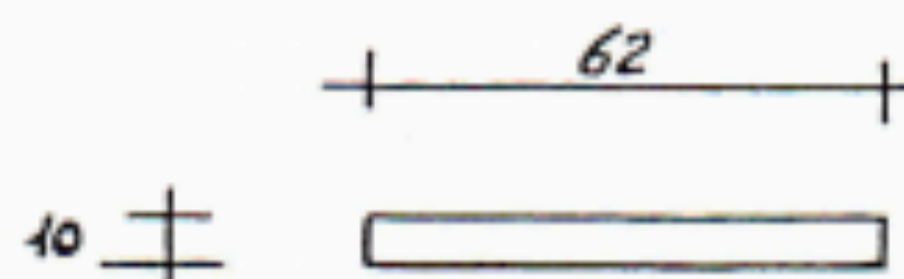

COPERCHIO SPESSORE CM. 10

Armatura: rete ϕ 5, maglia 15 x 15

Calcestruzzo: Rck 250

Peso Teorico: kg/m. 155 ~

Sollevamento: n. 2 ganci ϕ 6

Lunghezza: cm. 250

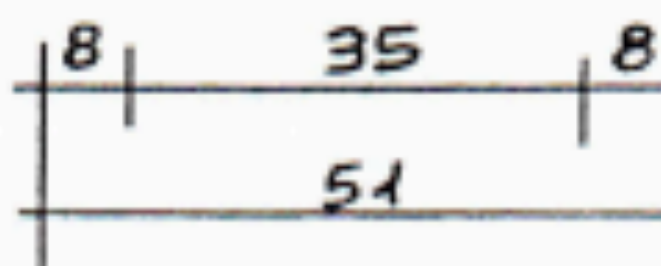
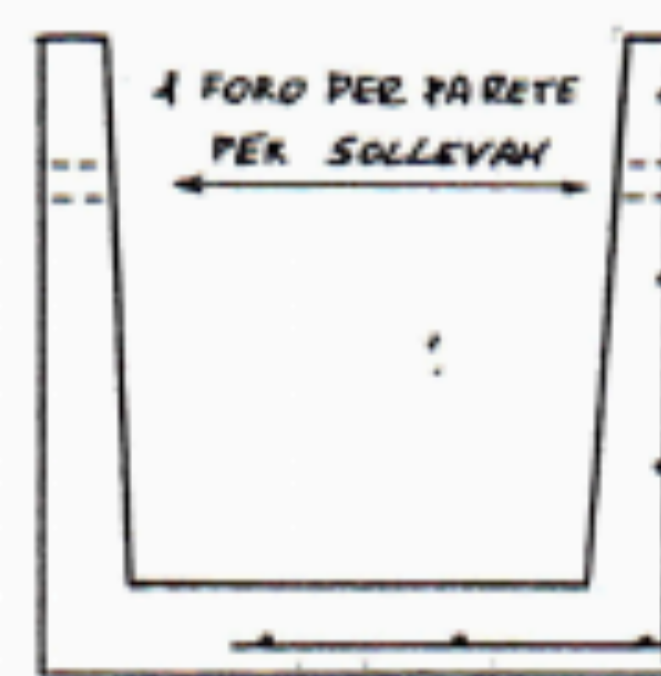
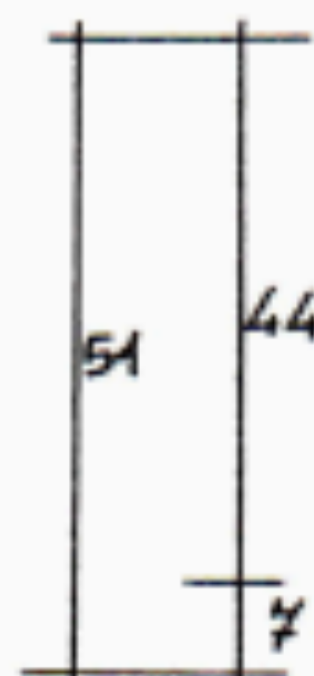
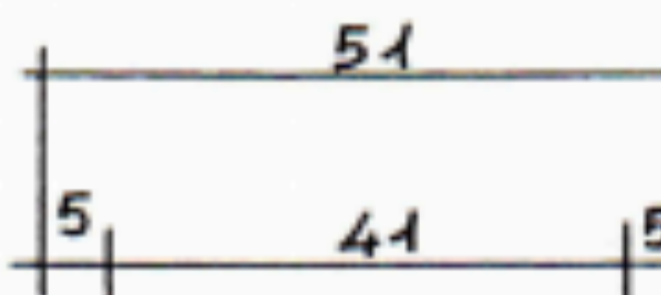
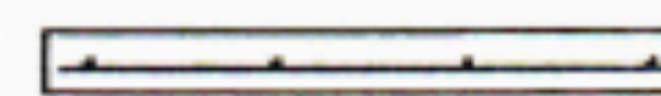

CANALE (COD: CNL 51)

Armatura: rete ϕ 5, maglia 15 x 15

Calcestruzzo: Rck 250

Peso Teorico: kg/m. 232 ~

Sollevamento: n. 1 foro per parete

Lunghezza: cm. 200

COPERCHIO SPESSORE CM. 10

Armatura: rete ϕ 5, maglia 15 x 15

Calcestruzzo: Rck 250

Peso Teorico: kg/m. 128 ~

Sollevamento: n. 2 ganci ϕ 6

Lunghezza: cm. 200